

# Da Round / Surface mount

Installation Instructions

PLEASE READ THESE INSTRUCTIONS PRIOR TO INSTALLING THIS PRODUCT

1. Disconnect electrical power from lighting circuit before installation.
2. CAUTION-RISK OF FIRE. This product must be installed in accordance with the applicable NEC/local installation code by a person familiar with the construction and operation of the product and the hazards involved.
3. Make sure LED drivers, Linear LED Modules and all other fixture components are present.
4. This installation assumes Class 2 two conductor wires have been run from fixture mount location to LED driver enclosure location.
5. Make wire connection from LED driver to two conductor Class 2 wire, running in wall/ceiling with wire nuts (not included).

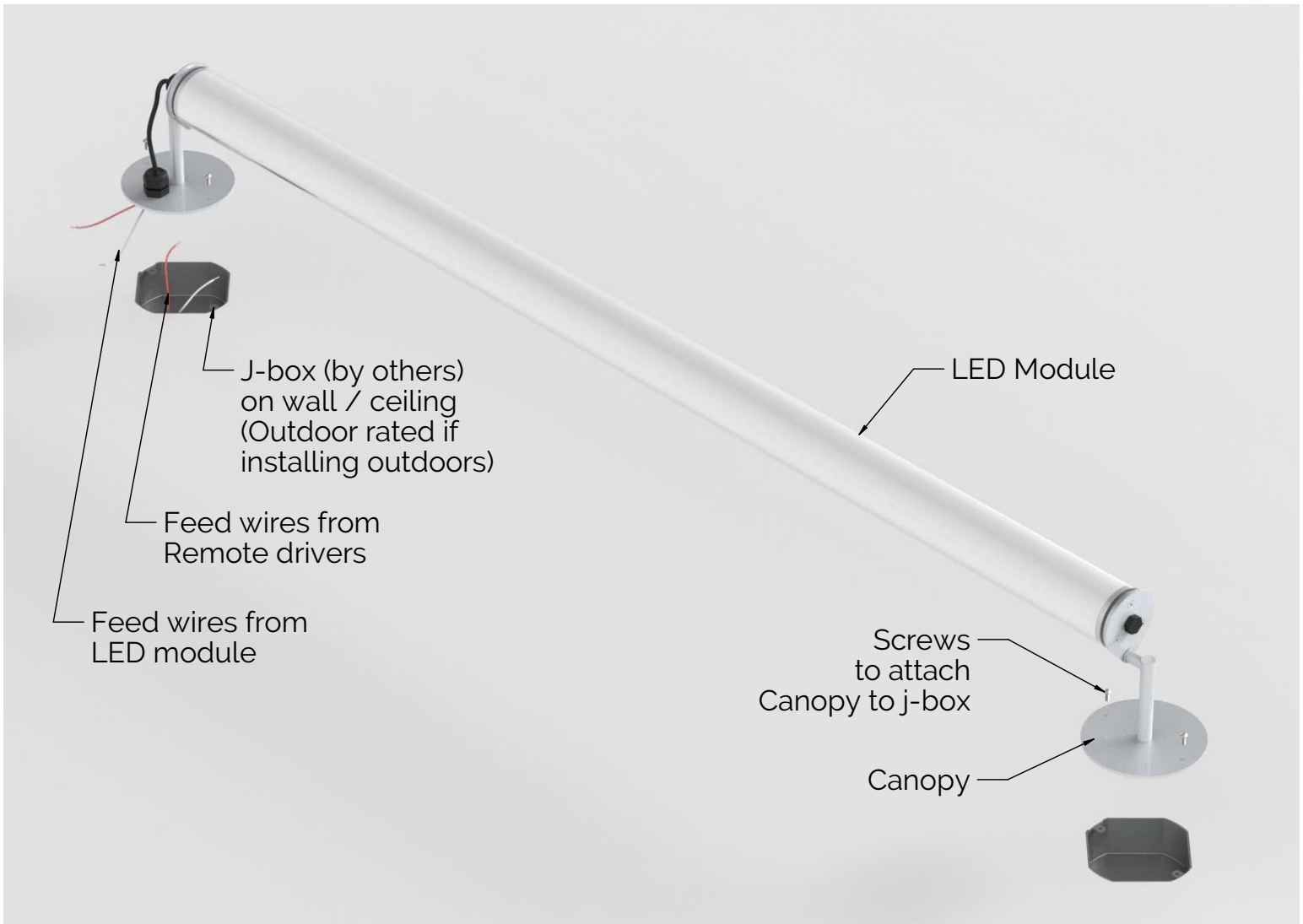

6. Make connection between the feed wire from LED to wires from remote drivers inside J-box using wire nuts (not provided). Make sure wire polarity from driver enclosure to fixture is correct.
7. Run bead of silicone seal around edge of canopy perimeter for outdoor installation.

# Da Round / Surface mount

Installation Instructions

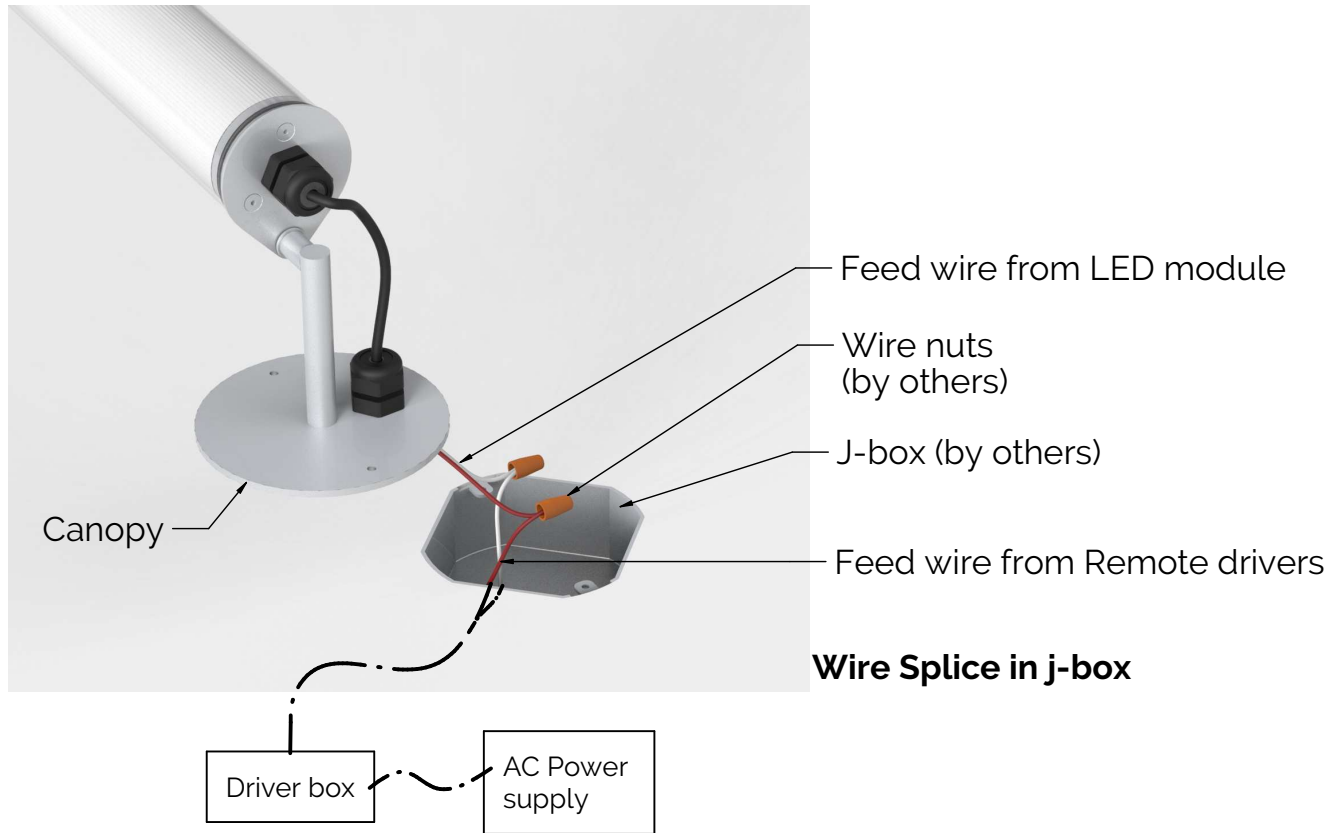

8. Secure the fixture and canopy to j-box using (4) #6-32 x 3/4" screws.
9. Make sure fixture is well secured to ceiling/wall and there are no pinched or exposed wires.
10. Make Mains power connection to LED driver using provided connector inside driver enclosure. Make sure Mains power Ground wire is secured to green ground wire inside driver enclosure.
11. Restore Main power.

