

Leesti Trimless Adjustable

Installation Instructions

1. Disconnect electrical power from lighting circuit before installation.
2. Installation should be consistent with local electrical codes, NEC and UL standards. This product must be installed in accordance with the applicable installation code by a person familiar with the construction and operation of the product and the hazards involved.
3. Make sure LED drivers, Linear LED Modules and fixture frame components are present.
4. Cut-out the opening in wall/ceiling for inserting Frame.
5. Initially the Clamp bracket is parallel to frame. In order to insert frame into Cut-out, make the clamp bracket to lift up and rotate it 90°, so that it causes no hinderance while inserting frame.

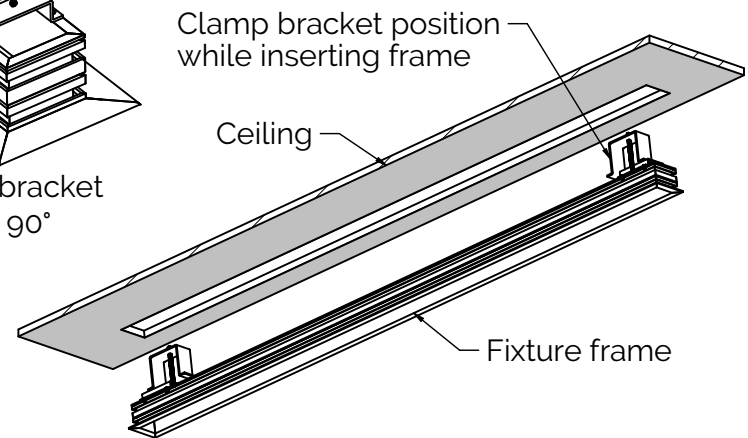
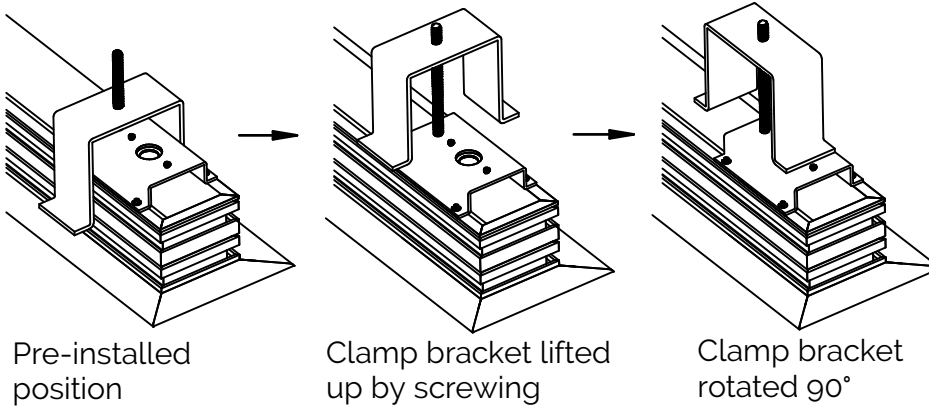
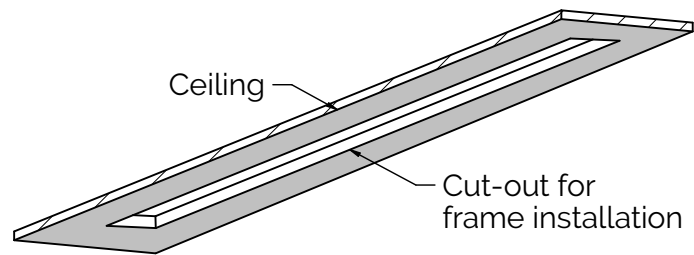
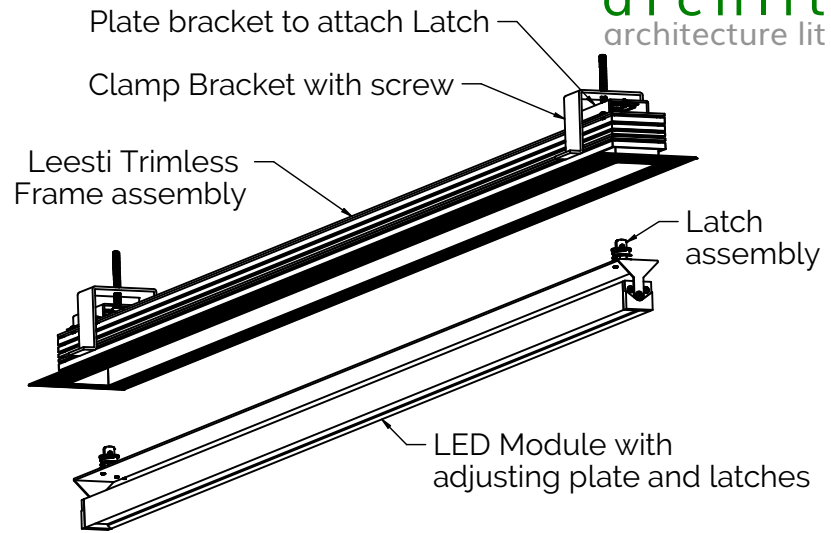

6. Insert fixture frame into ceiling opening so that only flange is seen at surface.
7. Loosen clamp bracket screw and rotate 90° again, so it slides down over frame.
8. Tighten clamp bracket screw until Clamp bracket has secured frame in ceiling opening. Donot over-tighten clamp bracket as it may damage the fixture.

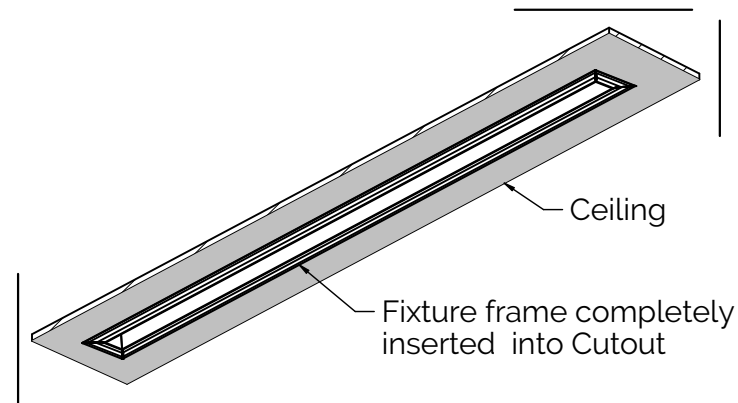

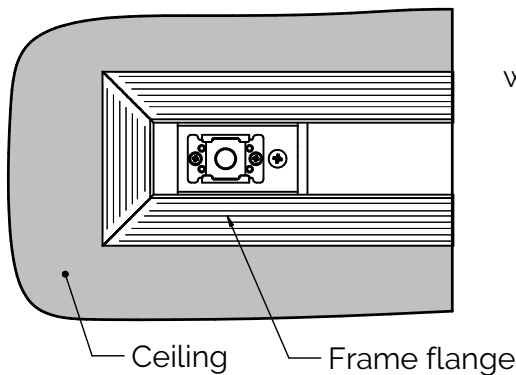

Frame flange covered with mud, giving finished look with ceiling.

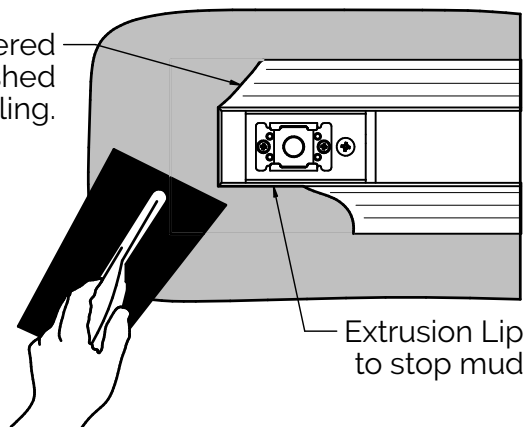

9. Use Mud around trimless edges of frame. Extrusion has lip for stopping mud (donot go over internal part of frame).

Feed from Remote driver, to be connected to LED module drivers

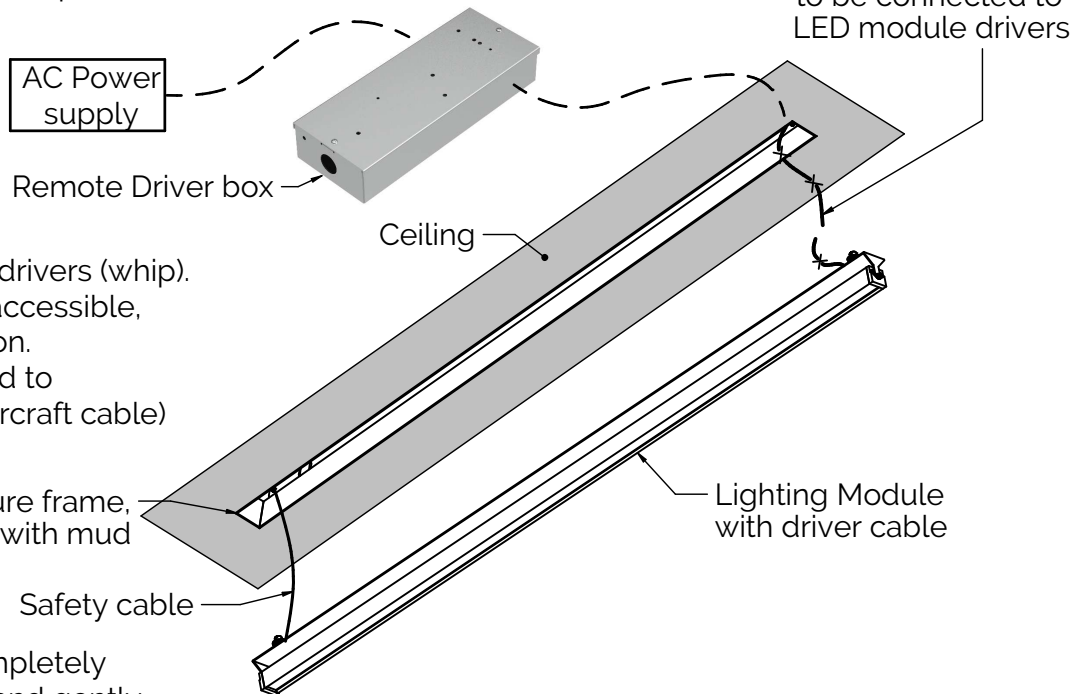

10. Connect LED module to Remote drivers (whip). Driver must be installed in a dry, accessible, and well ventilated remote location. Make sure LED module is attached to Fixture frame by a safety cable (aircraft cable) to avoid damage or injury.

11. Insert LED module into frame completely by aligning Latches to latch hole and gently pushing upwards untill a click is heard from spring Latches. LED module must be secured in fixture frame at this point.

12. Connect AC Power Lead from LED Drivers to disconnected Mains power. Apply main power to fixture.

Push up lighting modules to install. Push up and down to uninstall using pressure latches

